



**CONSTRUCTION CONTINUING ON WESTSIDE BLVD WIDENING PROJECT**

*Update as of Tuesday, Jan. 4, 2022*

**CONTACT** for questions and more information:

**Patti Watson**, 505-269-9691 cell; 505-245-3134 office; [pattiw@cwastrategic.com](mailto:pattiw@cwastrategic.com)

**NEW:** (Weather permitting) Beginning **Tuesday, Jan. 4, 2022**, and lasting for about four days, through **Friday, Jan. 7, 2022**, crews will pave the intersection of Grande Blvd and Westside Blvd.

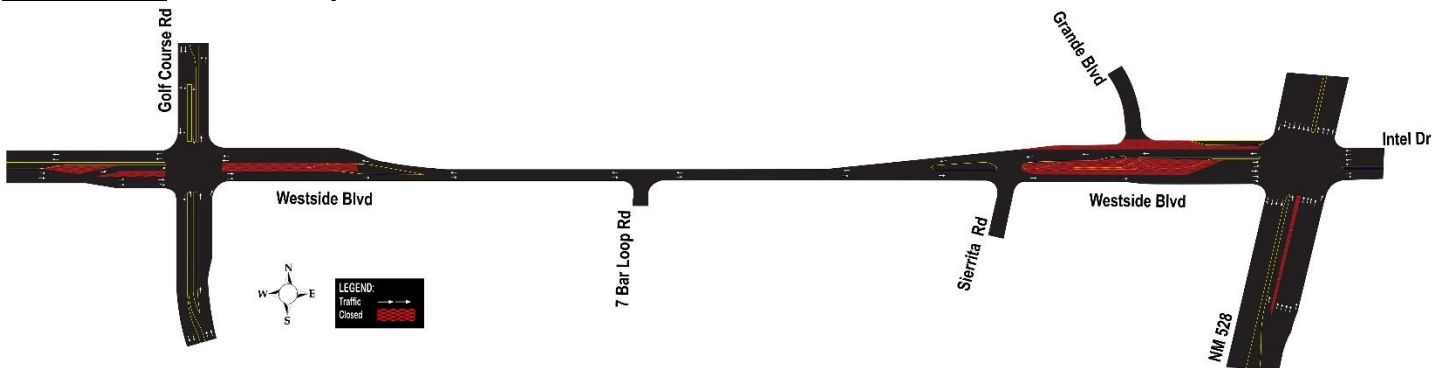

**During this closure, the following traffic impacts will be in place:**

- **Westbound traffic on Westside Blvd** will be detoured north on Golf Course Rd, then east on 19<sup>th</sup> Ave to access Grande Blvd.
- **Northbound traffic on Grande Blvd** will be detoured west on 19<sup>th</sup> Ave, then south on Golf Course Rd to access Westside Blvd.
- **Traffic on Grande Blvd** will continue to be able to access NM 528 from 21<sup>st</sup> Ave.

**ONGOING:** The following traffic impacts remain in place:

- **Westbound motorists on Westside Blvd** are able to turn right and head north and turn left and head south on Golf Course Rd, or head straight on Westside Blvd.
- **Eastbound motorists on Westside Blvd** are split with two lanes to the south to turn right and head south on Golf Course Rd or head straight on Westside Blvd, and a separate lane to the north to turn left and head north on Golf Course Rd.

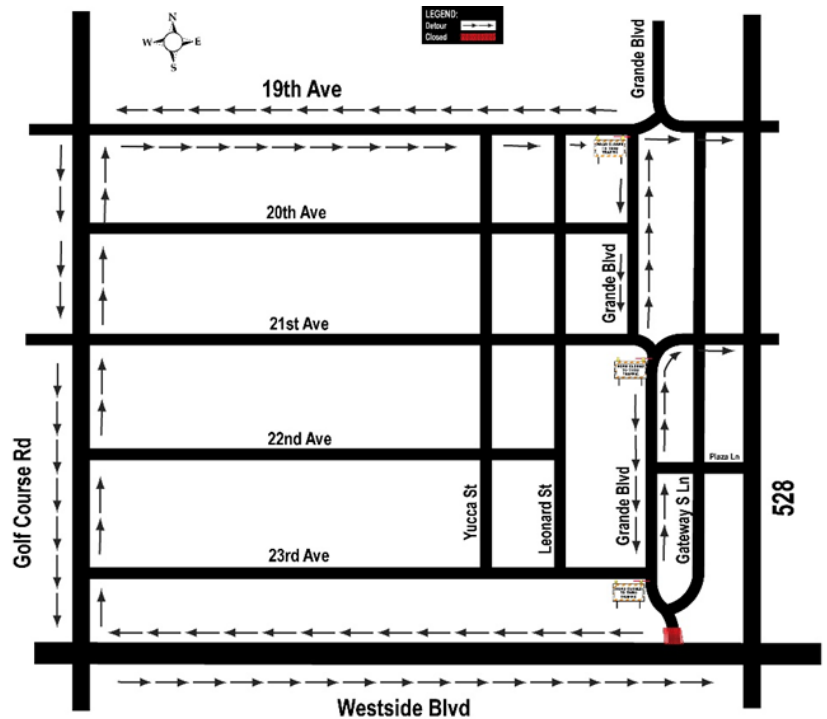

Regular work hours are **Mon.-Fri., 6:30 a.m.-5 p.m.**, although the contractor may work longer hours or on weekends if needed. *All construction is weather permitting and subject to change without notice.*