



**CONSTRUCTION CONTINUING ON WESTSIDE BLVD WIDENING PROJECT**

*Update as of Friday, Jan. 28, 2022*

**CONTACT** for questions and more information:

Patti Watson, 505-269-9691 cell; 505-245-3134 office; [pattiw@cwastrategic.com](mailto:pattiw@cwastrategic.com)

**NEW: Beginning Monday, Jan. 31, and lasting for about two weeks, through Monday, Feb. 14, crews will continue work in the center of Westside Blvd from east of Golf Course Rd to west of NM 528. They will also be working on the north side of Westside Blvd from just west of NM 528 to Grande Blvd. The turn bay from eastbound Westside Blvd to northbound NM 528 will be open to allow dedicated left-hand turns and one thru lane for eastbound traffic.**

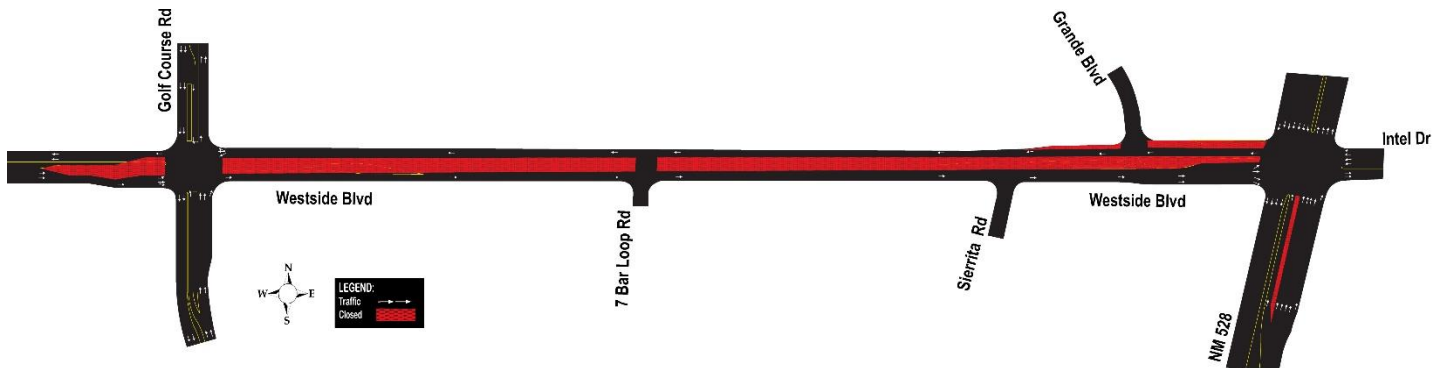

**During this construction, the following traffic impacts will continue to be in place:**

- **Westbound traffic on Westside Blvd will continue to be reduced to one lane between NM 528 and Golf Course Rd**
- **Westbound traffic will be able to turn left to access 7 Bar Loop Rd**
- **Westbound traffic will not be able to turn left to access Sierrita Rd and should use 7 Bar Loop Rd to access Sierrita Rd**
- **Eastbound traffic on Westside Blvd will be reduced to one lane between Golf Course Rd and NM 528**
- **Eastbound traffic will not be able to turn left to access Grande Blvd, but can access Grande by turning left and heading north on NM 528, then turning left and heading west on 21<sup>st</sup> Ave SE to Grande Blvd**

Regular work hours are **Mon.-Fri., 6:30 a.m.-5 p.m.**, although the contractor may work longer hours or on weekends if needed. ***All construction is weather permitting and subject to change without notice.***