



**CONSTRUCTION CONTINUING ON WESTSIDE BLVD WIDENING PROJECT**

*Update as of Thursday, Nov. 18, 2021*

**CONTACT** for questions and more information:

**Patti Watson, 505-269-9691** cell; **505-245-3134** office; [pattiw@cwastrategic.com](mailto:pattiw@cwastrategic.com)

**For information or to sign up for email construction updates, visit:** [www.westsidewidening.com](http://www.westsidewidening.com)

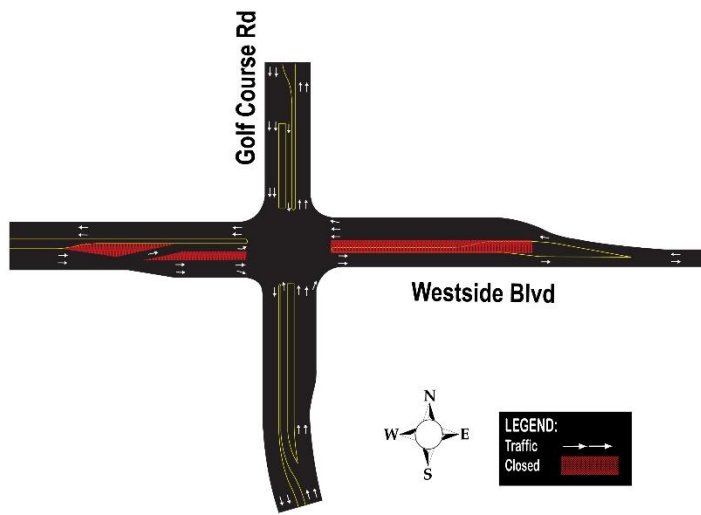

**NEW:** Beginning **Friday, Nov. 19, 2021**, and lasting through the **end of December 2021**, crews will begin working in the median just west of the intersection of Golf Course Rd and Westside Blvd. Traffic impacts for this work will include:

- Westbound motorists on Westside Blvd will be able to turn right and head north, turn left and head south on Golf Course Rd, or head straight on Westside Blvd.
- Eastbound motorists on Westside Blvd will be split with two lanes to the south to turn right and head south on Golf Course Rd or head straight on Westside Blvd, and a separate lane to the north to turn left and head north on Golf Course Rd. *(See map to left.)*

**ONGOING:** Grande Blvd is now open from the westbound lanes of Westside Blvd. *(See map to right).*

- Westbound motorists on Westside Blvd are able to turn right and head north on Grande Blvd.
- Southbound motorists on Grande Blvd are able to turn right and head west on Westside Blvd.

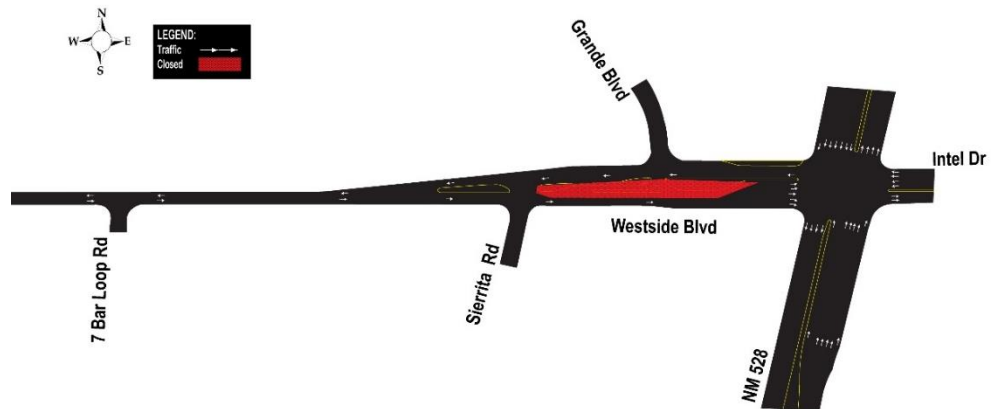

However, due to ongoing work in the far left-hand lane of Westside Blvd, **eastbound motorists on Westside will not be able to access Grande Blvd by turning left.** They can access Grande Blvd by heading north on NM 528 and turning left at 21<sup>st</sup> Ave. This part of construction is expected to last through **mid to late December.**

Regular work hours are **Mon.-Fri., 6:30 a.m.-5 p.m.**, although the contractor may work longer hours or on weekends if needed. **Crews will not be working Thursday, Nov. 25, or Friday, Nov. 26, in observance of the Thanksgiving holiday, but all barricades will remain in place for safety. All construction is weather permitting and subject to change without notice.**