



CONSTRUCTION CONTINUING ON WESTSIDE BLVD WIDENING PROJECT

Update as of Friday, Nov. 12, 2021

CONTACT for questions and more information:

Patti Watson, 505-269-9691 cell; **505-245-3134** office; pattiw@cwastrategic.com

For information or to sign up for email construction updates, visit: www.westsidewidening.com

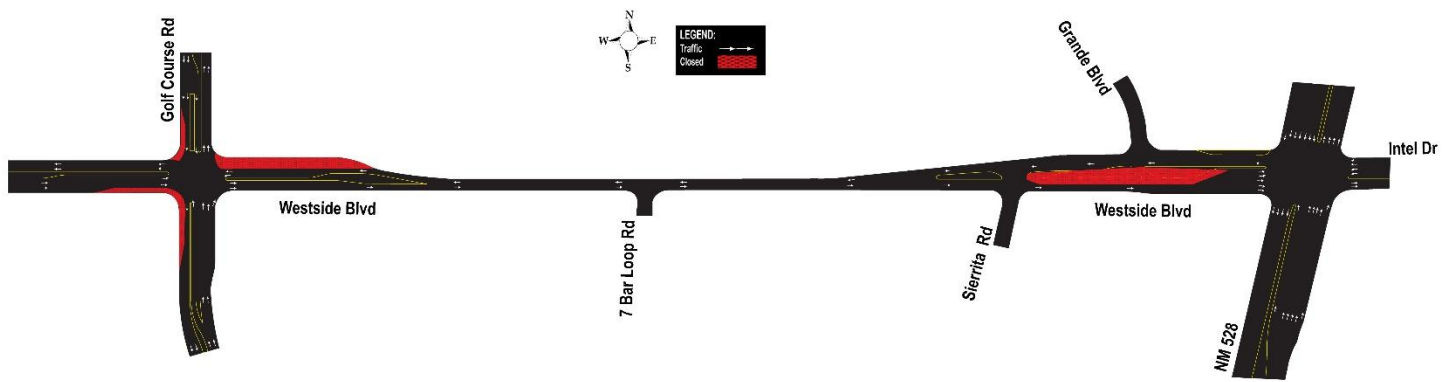

NEW: By the end of the day on **Friday, November 12, 2021**, crews will open access to Grande Blvd from the westbound lanes of Westside Blvd.

- Westbound motorists on Westside Blvd will be able to turn right and head north on Grande Blvd.
- Southbound motorists on Grande Blvd will be able to turn right and head west on Westside Blvd.

However, due to ongoing work in the far left-hand lane of Westside Blvd, **eastbound motorists on Westside will not be able to access Grande Blvd by turning left.** They can access Grande Blvd by heading north on NM 528 and turning left at 21st Ave.

ONGOING: All but one lane of westbound Westside Blvd is closed from NM 528 to west of Grande Blvd. Westside Blvd has westbound traffic shifted east and west of Golf Course Rd, with traffic reduced to one lane west of Golf Course Rd.

Regular work hours are **Mon.-Fri., 6:30 a.m.-5 p.m.**, although the contractor may work longer hours or on weekends if needed. *All construction is weather permitting and subject to change without notice.*